



## Maniglie passanti

Di forma circolare le maniglie passanti si prestano a diversi usi funzionali, specialmente in ambiti tecnici (armadi, scarpiera, etc)

### Two-way pull handle

These round two-way pull handles are suitable for various functional uses, especially in technical areas (wardrobes, shoe racks, etc.).

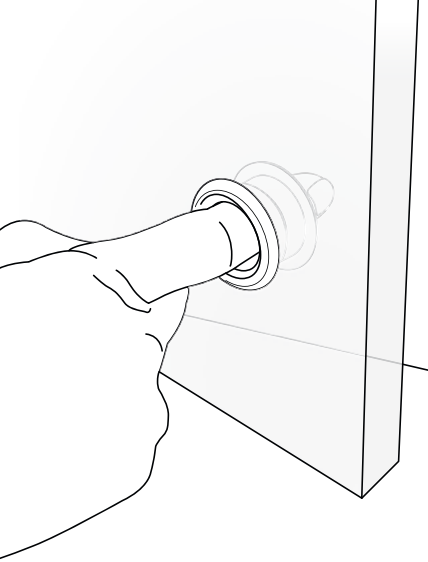

**087** Senza fondo  
Without base  
Ø 29 h 20  
VE VS VG GA SP

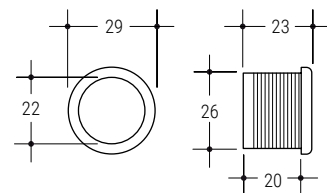

**087B** Senza fondo  
Without base  
Ø 29 h 19  
VE VS VG GA SP

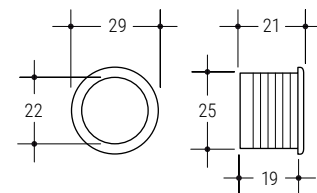

**362** Senza fondo  
Without base  
Ø 33 h 15  
VE VS VG VM SP

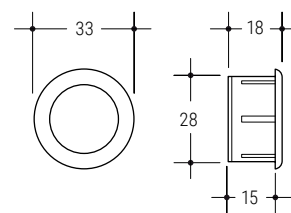

**1696** Senza fondo  
Without base  
Ø 40 h 22  
VE VS VG VM SP

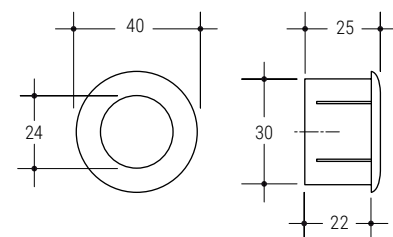

nota: La quota "h" è riferita alla profondità dell'incasso.  
note: The size "h" is referred to the built-in depth.



**078** Fondo cieco  
Dead end  
Ø 37 h 5  
VE VS VG VM GA SP

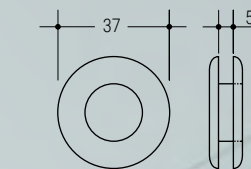

**078C** Ø 35 h 5  
VE VS VG VM GA SP

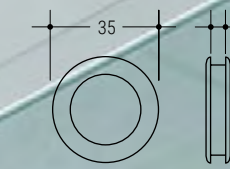

**078B** Ø 30,5 h 5  
VE VS VG VM GA SP

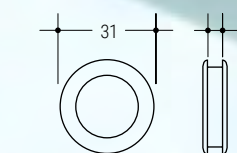

**078A** Ø 24 h 5  
VE VS VG VM GA SP



## Glass

Studiate specificatamente per le superfici trasparenti, le maniglie ad incasso Glass hanno uno spessore di soli 5 mm e sono rifinite su entrambe le facce per un uso passante.

Designed specifically for transparent surfaces: the Glass recessed handles are only 5 mm thick and finished on both sides for two-way use.

