

# SISTEMI DI GIUNZIONE Ø15

## CONNECTING FITTINGS Ø15

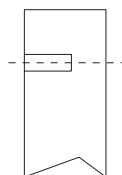
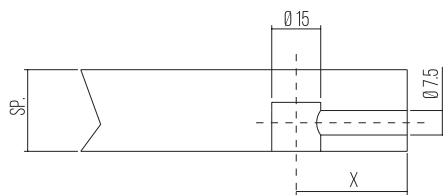

FORATURE DA ESEGUIRE  
DRILLING TO DO

X=34  
X=28  
X=24

### ECCENTRICI SENZA BORDO

#### EXCENTERS WITHOUT EDGE

MATERIALE: ZAMA  
MATERIAL: ZAMAK

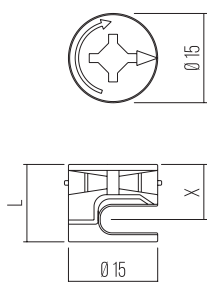
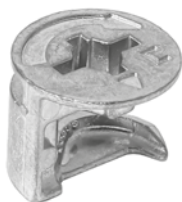

| ART.     | SP.   | L    | X    | 📦    |
|----------|-------|------|------|------|
| EX1515.. | 12    | 9.8  | 6    | 2500 |
| EX0115.. | 15    | 12   | 7.5  | 2500 |
| EX0215.. | 16    | 12.5 | 8    | 2500 |
| EX0315.. | 18    | 14   | 9    | 2500 |
| EX0415.. | 20    | 15   | 10   | 2500 |
| EX0515.. | 22    | 16   | 11   | 2500 |
| EX0615.. | 25    | 17.5 | 12.5 | 2500 |
| EX1615.. | 28/30 | 18.7 | 14.5 | 2500 |

FINITURE / FINISHES: ..GR ..ZB ..ZG ..VN ..ZN ..OT ..BR ..NI

### ECCENTRICI SENZA BORDO NEW

#### NEW EXCENTERS WITHOUT EDGE

MATERIALE: ZAMA  
MATERIAL: ZAMAK

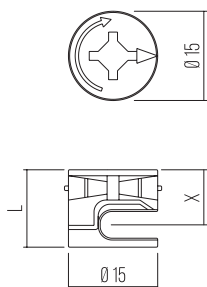

| ART.     | SP.   | L    | X    | 📦    |
|----------|-------|------|------|------|
| EX4215.. | 12    | 10   | 6    | 2500 |
| EX3415.. | 15/16 | 12   | 7.8  | 2500 |
| EX3515.. | 18    | 13   | 9    | 2500 |
| EX3615.. | 22    | 16.3 | 11   | 2500 |
| EX3715.. | 25    | 17.5 | 12.5 | 2500 |
| EX4015.. | 29/30 | 19.5 | 15   | 2500 |

FINITURE / FINISHES: ..GR ..ZB ..ZG ..VN ..ZN ..OT ..BR ..NI

### ECCENTRICI CON BORDO

#### EXCENTERS WITH EDGE

MATERIALE: ZAMA  
MATERIAL: ZAMAK

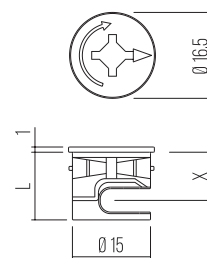

| ART.     | SP. | L    | X    | 📦    |
|----------|-----|------|------|------|
| EX2115.. | 12  | 10   | 6    | 2500 |
| EX3115.. | 16  | 12.5 | 8    | 2500 |
| EX0715.. | 18  | 14   | 9    | 2500 |
| EX0815.. | 25  | 17.5 | 12.5 | 2500 |
| EX4615.. | 28  | 20   | 14   | 2500 |

FINITURE / FINISHES: ..GR ..ZB ..ZG ..VN ..ZN ..OT ..BR ..NI