

Gli articoli di queste pagine sono disponibili anche nelle serie:

serie rotonda coniata 8000  
serie rotonda 7000  
serie piana 4000  
serie quadra 0000

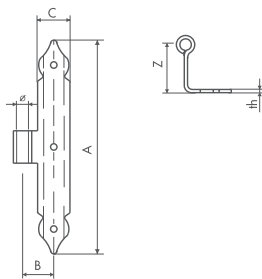

**ART. 1346/z Ø 10**  
**ART. 1366/z Ø 12**



**bandelle a T zancate**

"T"-shaped, 90° bent hinge  
T-förmiges band, gekröpft  
penture en "T" coudée à 90°

Articolo	A	B	C	ZC	ZM	Ø	th	Pz./Conf.
1346/ZC	160	31	28	35	*	10	3	12
1346/ZC	200	31	30	35	*	10	3	12
1346/ZM	160	31	28	*	45	10	3	12
1346/ZM	200	31	30	*	45	10	3	12
1366/ZC	200	25	30	35	*	12	3.5	12
1366/ZM	200	25	30	*	45	12	3.5	12

**ART. 1364 Ø 12**

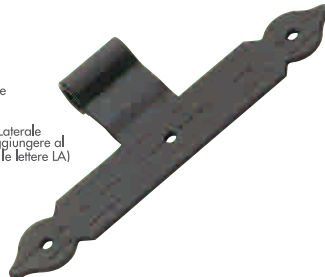
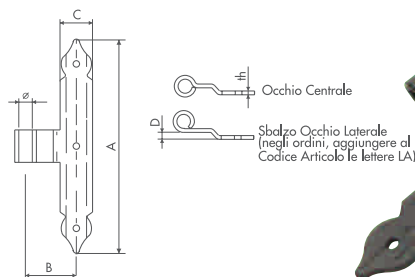

**bandelle a T con sbalzo**

"T"-shaped hinge with embossment  
T-förmiges band mit stufe  
penture en "T" avec relief

Articolo	A	B	C	D	Ø	th	Pz./Conf.
1364 con sbalzo	200	55	30	3	12	3.5	12
1364 con sbalzo	200	55	30	6	12	3.5	12
1364 collo lungo	200	65	30	3	12	3.5	12
1364 collo lungo	200	65	30	6	12	3.5	12

**ART. 1364/zf Ø 12**

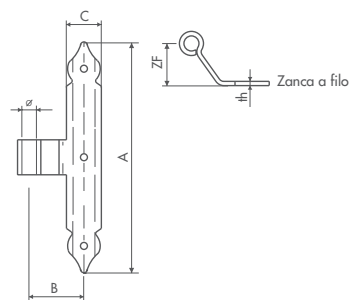

**bandelle a T zanca a filo 35 mm, collo lungo**

"T"-shaped, 45° bent hinge (long eye-hole distance) 35 mm  
T-förmiges band mit bündiger kröpfung, langarmig 35 mm  
penture en "T" avec coudée à 45°, bras long 35 mm

Articolo	A	B	C	ZF	Ø	th	Pz./Conf.
1364/ZF	200	45	30	35	12	3.5	12

**ART. 1389 Ø 12**

**NEW**

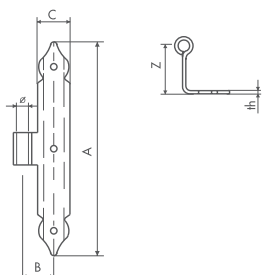

**bandelle a T zancate**

"T"-shaped, 90° bent hinge  
T-förmiges band, gekröpft  
penture en "T" coudée à 90°

Articolo	A	B		C	Z	ZF	Ø	th	Pz./Conf.
		occhio centrale	occhio laterale						
1389/ZC	200	42	48	30	35	*	12	3.5	24
1389/ZM	200	42	48	30	45	*	12	3.5	24
1389/ZL	200	42	48	30	60	*	12	3.5	24
media 1389/ZF	200	60	*	30	*	45	12	3.5	24