

## SUPPORTI TIPO "G" – (Cuscinetto Ø 42 mm)

WALL AND SCREW-FIXING SUPPORTS TYPE "G" – (ball bearing Ø 42 mm)

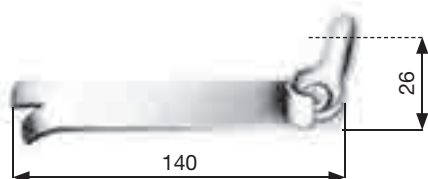

### SUPPORTO A MURARE TIPO "G"

WALL-FIXING SUPPORT TYPE "G"

133.S.14.20

Zincato – per cuscinetto Ø 42 mm  
Galvanized – for ball bearing Ø 42 mm

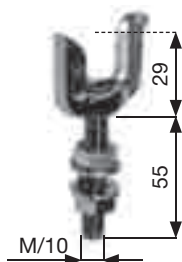

### SUPPORTO REGISTRABILE CON VITE TIPO "G"

ADJUSTABLE BEARING HOLDER TYPE "G"

146.P.00.20

Zincato – per cuscinetto Ø 42 mm  
Galvanized – for ball bearing Ø 42 mm

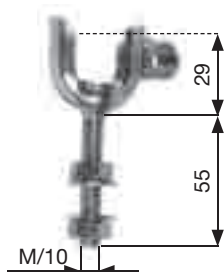

### SUPPORTO REGISTRABILE CON VITE TIPO "G" PER RIDUTTORE

ADJUSTABLE BEARING HOLDER "G" FOR REDUCTION PULLEY

146.P.RR.20

Zincato – per cuscinetto Ø 42 mm  
Galvanized – for ball bearing Ø 42 mm

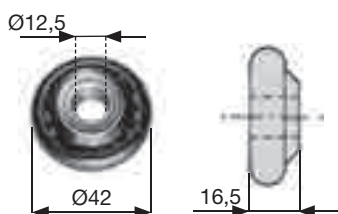

### CUSCINETTO A SFERE TIPO "G" Ø 42 mm

BALL BEARING TYPE "G" Ø 42 mm

145.C.FE.20

Zincato – boccia ferro, foro Ø12,5 mm  
Galvanized – iron bush, hole Ø 12,5 mm

145.C.NY.20

Zincato – boccia nylon, foro Ø12,5 mm  
Galvanized – nylon bush, hole Ø 12,5 mm

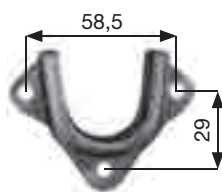

### SUPPORTO A CASSONETTO TIPO "G"

SCREW-FIXING SUPPORT TYPE "G"

150.S.00.20

Zincato – per cuscinetto Ø 42 mm  
Galvanized – for ball bearing Ø 42 mm

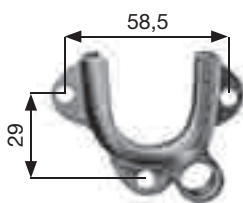

### SUPPORTO A CASSONETTO TIPO "G" CON FERMO PER RIDUTTORE

SCREW-FIXING SUPPORT TYPE "G" WITH STOP FOR REDUCTION PULLEY

150.S.GR.20

Zincato – per cuscinetto Ø 42 mm  
Galvanized – for ball bearing Ø 42 mm